

Meet Your New PERS

CL52 Emergency Response System

CL52 was created to provide you comfort, reassurance and peace of mind by making it possible for help to be just a touch of a button away.

Get to Know Your Unit

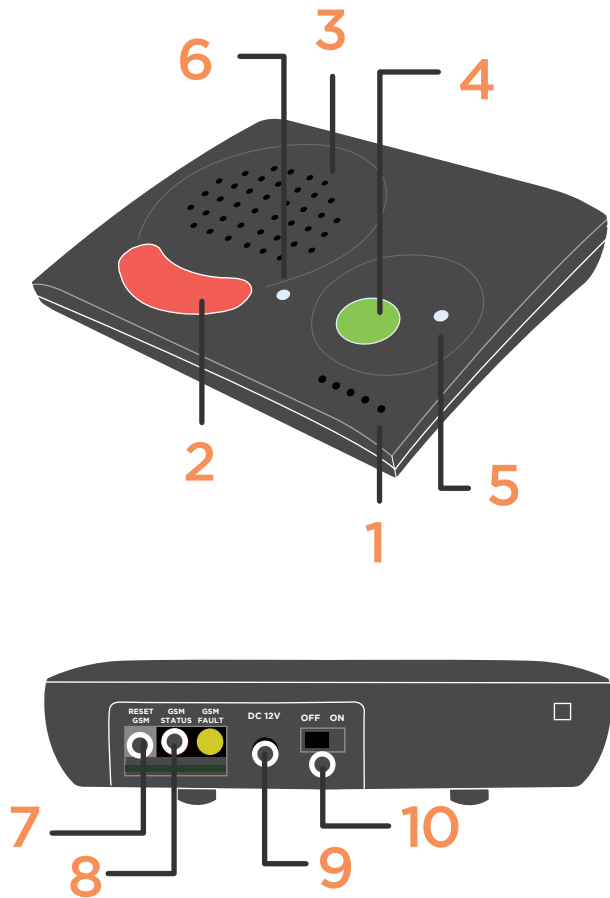

- 1 Microphone**
Used to communicate with the Care Center
- 2 Emergency Button**
Press to send emergency alarms to the Care Center
- 3 Speaker**
Used to listen to the Care Center
- 4 Reset Button**
Used for troubleshooting purposes only
- 5 Power Light**
Displays status of your unit (see below)
- 6 Alarm Status Light**
Solid light indicates the unit is calling the care center
Flashing light indicates unit is in programming mode
- 7 GSM Reset Button**
Press and Hold for 1 second to reset GPRS/3G module
- 8 GSM Light**
Indicates current cellular network signal connection status
- 9 Power Jack**
Connect with the provided AC adapter to a power outlet
- 10 On/Off Switch**
Switch on to power the unit

Unit Facts & Features:

- ◆ Fall detection available
- ◆ Two-way hands free communication
- ◆ The button can be worn around your wrist or neck
- ◆ Unit will perform silent self-tests to the Care Center
- ◆ Please test your unit monthly to ensure it is working properly
- ◆ Uses cellular network connection
- ◆ Powerful 3W speaker for clear communication
- ◆ Battery back-up in case of power outage
- ◆ Water-resistant button

Power Light:

- **Solid Green-** Unit is operating on AC power
- **Flashing Green-** Unit is running on back-up battery or low PHB battery
- ◆ For additional questions, call tech support at **1-800-860-4230**